

Sheaves

10C/QD STYLE

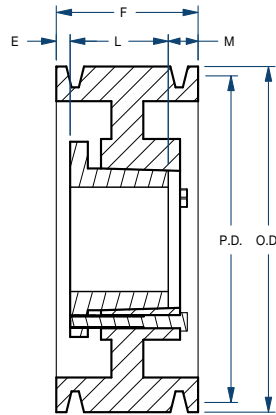

BLACKSTAR®



Type A

Part No.	Bushing	Bore Range (in)	Type	Diameter (in)		Dimensions (in)				Weight less Bushing (lbs)
				Pitch	Outside	E	F	L	M	
10C80E	E	7/8 – 3-1/2	A	8.0	8.40	2-1/32	10-1/4	2-3/4	5-15/32	65.0
10C85E	E	7/8 – 3-1/2	A	8.5	8.90	2-1/32	10-1/4	2-3/4	5-15/32	69.0
10C90J	J	1-1/2 – 4-1/2	A	9.0	9.40	2-1/16	10-1/4	4-5/8	3-9/16	73.0
10C95J	J	1-1/2 – 4-1/2	A	9.5	9.90	2-1/16	10-1/4	4-5/8	3-9/16	79.0
10C100J	J	1-1/2 – 4-1/2	A	10.0	10.40	2-1/16	10-1/4	4-5/8	3-9/16	84.0
10C105J	J	1-1/2 – 4-1/2	A	10.5	10.90	2-1/16	10-1/4	4-5/8	3-9/16	95.0
10C110J	J	1-1/2 – 4-1/2	A	11.0	11.40	2-1/16	10-1/4	4-5/8	3-9/16	104.0
10C120J	J	1-1/2 – 4-1/2	A	12.0	12.40	2-1/16	10-1/4	4-5/8	3-9/16	113.0
10C130J	J	1-1/2 – 4-1/2	A	13.0	13.40	2-1/16	10-1/4	4-5/8	3-9/16	121.0
10C140J	J	1-1/2 – 4-1/2	A	14.0	14.40	2-1/16	10-1/4	4-5/8	3-9/16	128.0
10C160J	J	1-1/2 – 4-1/2	A	16.0	16.40	2-1/16	10-1/4	4-5/8	3-9/16	146.0
10C180J	J	1-1/2 – 4-1/2	A	18.0	18.40	2-1/16	10-1/4	4-5/8	3-9/16	161.0
10C200J	J	1-1/2 – 4-1/2	A	20.0	20.40	2-1/16	10-1/4	4-5/8	3-9/16	175.0
10C240M	M	2 – 5-1/2	A	24.0	24.40	9/32	10-1/4	6-3/4	3-7/32	265.0
10C300M	M	2 – 5-1/2	A	30.0	30.40	9/32	10-1/4	6-3/4	3-7/32	310.0
10C360M	M	2 – 5-1/2	A	36.0	36.40	9/32	10-1/4	6-3/4	3-7/32	345.0
10C440M	M	2 – 5-1/2	A	44.0	44.40	9/32	10-1/4	6-3/4	3-7/32	450.0
10C500M	M	2 – 5-1/2	A	50.0	50.40	9/32	10-1/4	6-3/4	3-7/32	500.0